



7D Kinematic Metrology

Datasheet

iGPS ACCESSORIES

The following iGPS accessories compliment existing iGPS or iSpace systems & components. When selecting an accessory pay close attention to the compatibility section to ensure the product you select is right for you.

NOTE: The standard power supply cordsets are for North American plugs, please indicate when ordering if alternate cordsets are required.

G6.0 PCE DIGITAL INPUT MODULE (0106144)

The Digital Input Module (DIM) allows up to 4 independent external events to be synchronized with iGPS measurements. The external electrical event is linked to one of four DIM channels and each event occurrence is digitized and time stamped in Surveyors time base. Each DIM channel has an LED which indicates when an event is received.

In Surveyor the digital events can be used as pure timed events with no associated action or can be configured to perform any of the following actions:

- Capture – Captures the current position of the assigned frame
- Undo – Undoes the last action
- Change Mode – Cycles through the measurement modes
- Change Tip – Cycles through the assigned frames tips



COMPATIBILITY

The G5.1 PCE DIM (0106144) is compatible with i5IS (0105867, 0105868).

TECHNICAL SPECIFICATIONS

Part Number	0106144
Size	70mm x 40mm x 20mm (2.75" x 1.57" x 0.79") 170mm (7.7") cable length
Weight	45g (5.3oz)
Operating Temperature (non-condensing)	0 deg C to 40 deg C (32F to 104F)
Storage Temperature (non-condensing)	-20 deg C to 60 deg C (-4F to 140F)
Connectors	1 x 6 pin PCE connector with twist lock and alignment guide 1 x 5 position removable rising clamp terminal block

Electrical Input Specifications	No. of Inputs	4 (sink/source)
	Input Voltage	10.8 – 26.4 VDC
	Input Peak Voltage	30.0 VDC
	Input Current Typical	4.0 mA @ 12 VDC 8.5 mA @ 24 VDC
	Maximum Input Current	11 mA @ 26.4 VDC
	Input Impedance	2.8 KOhm @ 12-24 VDC
	On Voltage Level	10.0 VDC
	Off Voltage Level	2.0 VDC
	Minimum On Current	3.5 mA
	Maximum Off Current	0.5 mA
	Off to On Response1	4ms
	On to Off Response1	4ms
	Maximum F-Response	32Hz
	Commons	1
	Fuse	None
	Terminal Type	Removable rising clamp terminal block 14-28 AWG conductor



7D KINEMATIC METROLOGY

13-14 55 Fleming Dr
Cambridge, Ontario, Canada
N1T 2A9
www.7DKMetrology.com
info@7DKMetrology.com

i6 PROBE BATTERY (0063474)

The i6 probe battery is a Smart Li Ion Battery with an always active 5 segment LCD fuel gauge. The battery has a runtime of approximately 4 hours when used with the i6 Probe.



COMPATIBILITY

The i6 Probe Battery (0063474) is compatible with the i6 Probe and Battery Charger (0062186).

TECHNICAL SPECIFICATIONS

Part Number	0063474
Size	59mm x 85mm x 22mm (2.3" x 3.3" x 0.9")
Weight	174g (6.1oz)
Operating Temperature (non-condensing)	0 deg C to 45 deg C (32F to 113F)
Storage Temperature (non-condensing)	-20 deg C to 60 deg C (-4F to 140F)
Voltage & Capacity	10.8V, 2.6Ah
Full Cycle Run Time ¹	4 hrs

¹ Typical results when used in an 8 transmitter system



7D KINEMATIC METROLOGY

13-14 55 Fleming Dr
Cambridge, Ontario, Canada
N1T 2A9
www.7DKMetrology.com
info@7DKMetrology.com

G5.1 PCE BATTERY (0064157)

The G5.1 PCE battery is a Smart Li Ion Battery with an always active 5 segment LCD fuel gauge. The battery has a runtime of approximately 6 hours when used with a G5.1 PCE.



COMPATIBILITY

The G5.1 PCE Battery (0064157) is compatible with G5.1 PCEs (0061985, 0061986) and the Battery Charger (0062186).

TECHNICAL SPECIFICATIONS

Part Number	0064157
Size	59mm x 85mm x 22mm (2.3" x 3.3" x 0.9")
Weight	174g (6.1oz)
Operating Temperature (non-condensing)	0 deg C to 45 deg C (32F to 113F)
Storage Temperature (non-condensing)	-20 deg C to 60 deg C (-4F to 140F)
Voltage & Capacity	10.8V, 2.6Ah
Full Cycle Run Time ¹	6 hrs

¹ Typical results when used in an 8 transmitter system



7D KINEMATIC METROLOGY

13-14 55 Fleming Dr
Cambridge, Ontario, Canada
N1T 2A9
www.7DKMetrology.com
info@7DKMetrology.com

PRECISION TOOLING PAD (0063447)

The Precision Tooling Pad allows for quick and easy deployment of a mini vector bar or single detector. The tooling pad features a 4 hole counter-bored bolt pattern for semi-permanent attachment to the part of interest as well as a precision 1/4" mounting socket for repeatable deployment of the mini vector bar or detector.

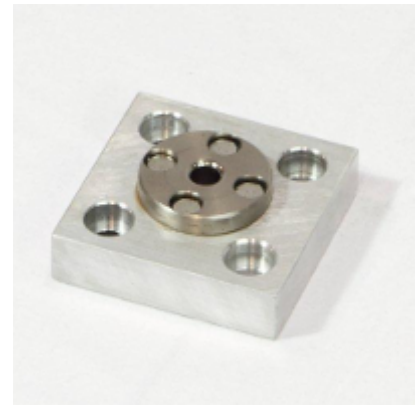

COMPATIBILITY

The Precision Tooling Pad (0063447) is compatible with mini vector bars (0060519) and single detectors (0060511).

TECHNICAL SPECIFICATIONS

Part Number	0063447
Size	51mm x 51mm x 18mm (2" x 2" x 0.71")
Weight	105g (3.7oz)
Mechanical Interface	4 x 1/4" counter-bored hole pattern Slip fit magnetic socket for 1/4" shank

PHYSICAL DIMENSIONS & TOLERANCES

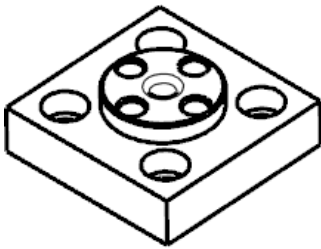

ISO VIEW

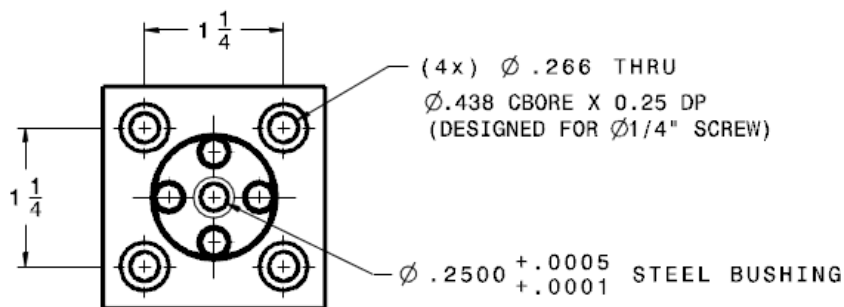

TOP VIEW



7D KINEMATIC METROLOGY

13-14 55 Fleming Dr
 Cambridge, Ontario, Canada
 N1T 2A9
www.7DKMetrology.com
info@7DKMetrology.com

TRANSMITTER BATTERY (0064111)

The transmitter battery pack is a Smart Li Ion Battery with an integrated charger and tripod mountable pack. The battery has a runtime of approximately 10 hours when used with a metrology grade transmitter. The batteries integrated charger allows it to be connected to the included power supply and charged in place without interrupting the transmitter power or it can be removed from the tripod and charged at the workstation. The transmitter power cable has a cable-cable quick disconnect allowing the battery to be swapped with touching the transmitter.



COMPATIBILITY

The transmitter battery (0064111) is compatible with the metrology grade transmitter (0060551) and the Battery Charger (0062186).

TECHNICAL SPECIFICATIONS

Part Number	0064111
Size	125mm x 200mm x 35mm (4.9" x 7.9" x 1.4")
Weight	922 g (2lb)
Operating Temperature (non-condensing)	0 deg C to 45 deg C (32F to 113F)
Storage Temperature (non-condensing)	-20 deg C to 60 deg C (-4F to 140F)
Voltage & Capacity	10.8V, 8.8Ah
Full Cycle Run Time	10 hrs
Transmitter Power Cable Connectors	1 x 4 pin transmitter connector with push-pull automatic locking and alignment guide 1 x quick-disconnect cable-cable connector
Charger Power Supply Input	IEC320-C14 Inlet, 100-240VAC, 50-60Hz



7D KINEMATIC METROLOGY

13-14 55 Fleming Dr
Cambridge, Ontario, Canada
N1T 2A9
www.7DKMetrology.com
info@7DKMetrology.com

TRANSMITTER POWER SUPPLY (0060510)

The transmitter power supply accepts international AC and converts it to 12 VDC. The transmitter power supply connector is a 4 pin connector with push-pull automatic locking and alignment guide to prevent misconnection or accident damage to the transmitter or pins.



COMPATIBILITY

The transmitter power supply (0060510) is compatible with the metrology grade transmitter (0060551).

TECHNICAL SPECIFICATIONS

Part Number	0060510
Size	119mm x 60mm x 32mm (4.7" x 2.4" x 1.3") 1.8m (72") transmitter cable length
Weight	270g (9.5oz)
Operating Temperature (non-condensing)	0 deg C to 40 deg C (32F to 104F)
Storage Temperature (non-condensing)	-20 deg C to 60 deg C (-4F to 140F)
Output Power	12VDC, 3.35A , 4 pin connector with push-pull automatic locking and alignment guide
Input Power	IEC320-C14 Inlet, 100-240VAC, 50-60Hz



7D KINEMATIC METROLOGY

13-14 55 Fleming Dr
Cambridge, Ontario, Canada
N1T 2A9
www.7DKMetrology.com
info@7DKMetrology.com

BATTERY CHARGER (0062186)

The Battery Charger is a smart charger/calibrator for PCE, i6 Probe, and Transmitter batteries. It provides the capability to carry out charging and fuel gauge calibration of the battery.



COMPATIBILITY

The Battery Charger (0062189) is compatible with G3 PCE, G5 PCE, G5.1 PCE (0064157), i6Probe (0063474), and Transmitter (0064111) batteries.

TECHNICAL SPECIFICATIONS

Part Number	0062186
Size	92mm x 180mm x 58mm
Weight	235 g
Operating Temperature (non-condensing)	0 deg C to 45 deg C (32F to 113F)
Storage Temperature (non-condensing)	-20 deg C to 70 deg C (-4F to 158F)
Full Cycle Charge Time	4hrs for PCE & i6 Probe batteries 4.5hrs for transmitter batteries
Included Power Supply	IEC320-C14 Inlet, 100-240VAC, 50-60Hz (North American plug supplied)



WIRELESS ACCESS POINT KIT (0064107, 0108751)

The wireless access point (WAP) kit enables communication to wireless devices in the system. The WAP kit includes a MOXA AWK-4121 industrial IEEE 802.11a/b/g IP-68 rated WAP along with 2 dual band omni-directional antennas and choice of power source. The WAP comes preconfigured for use with desired iGPS devices.



COMPATIBILITY

The WAP kit (0064107, 0108751) is compatible with all wireless devices and workstations.

TECHNICAL SPECIFICATIONS

Part Number	0064107 – with standard power adapter 0108751 – with battery for remote deployment Manufacturer: Moxa AWK-4121
Size	224mm x 148mm x 65mm (8.8" x 5.8" x 2.5")
Weight	1.5kg (3.3lb)
Manufacturers Part Number	Moxa AWK 4121 See the Manufacturers datasheet for more details available at: http://www.moxa.com/product/AWK-4121.htm



7D KINEMATIC METROLOGY

13-14 55 Fleming Dr
Cambridge, Ontario, Canada
N1T 2A9
www.7DKMetrology.com
info@7DKMetrology.com